

達而特企業股份有限公司

黃金鋁殼電阻 Aluminum Housed Wirewound Resistors 規格書

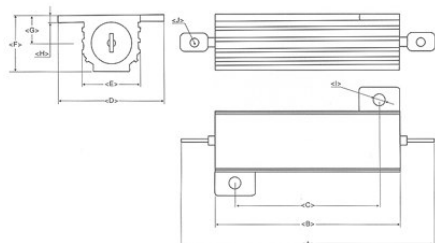

GSH-5W
GSH-10W
GSH-25W
GSH-50W

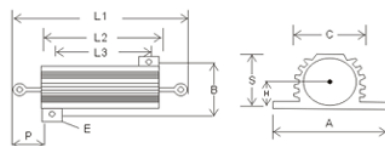

GSH-80W
GSH-100WS

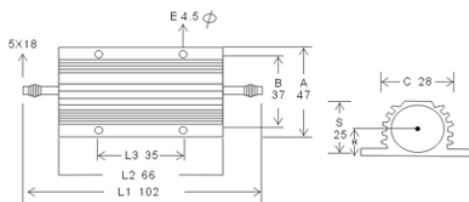

GSH-100W

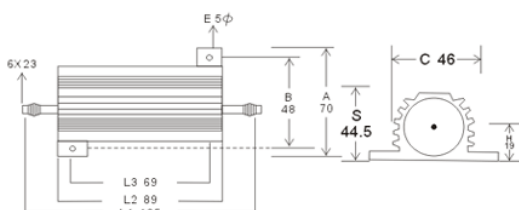

GSH-200W
GSH-250W
GSH-300W

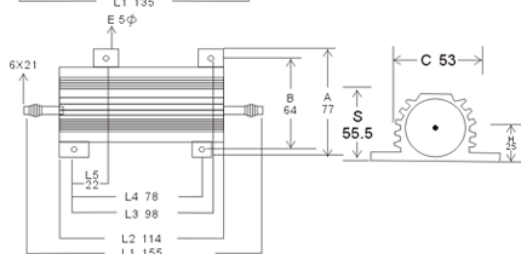

Type	DIMENSIONS(mm)											Resistance Range
	L1±2	L2±1	L3±1	A±1	B±1	C±1	E±0.3	S±1	H±0.5	P±2		
GSH-5W	25	15	10	16.5	12.5	8.5	2	8	4	5	0.1Ω~50K	
GSH-10W	32	19	14	20	15.5	10.5	2	10	5	6	0.1Ω~50K	
GSH-25W	47	27	18	27	19	15	3.2	15.5	7	10	0.1Ω~100K	
GSH-50W	70	50	39	29	21	15	3.2	15.5	7	10	0.1Ω~100K	
GSH-80W	102	66	35	47	37	28	4.5	25	12	5*18	0.1Ω~100K	
GSH-100WS	102	66	35	47	37	28	4.5	25	12	5*18	0.1Ω~100K	
GSH-100W	135	89	69	70	48	46	5	44.5	19	6*23	0.1Ω~3K	
GSH-250W	155	114	98	77	64	53	5	55.5	25	6*21	0.1Ω~3K	

Short-time Overload Rating

Load Time (Second)	1	2	3	4	5	10	30	60	180	300	600	900
Power Incerase (%)	2600	2000	1600	1400	1300	1000	600	450	200	150	120	110

Electrical Specification

Characteristics	Limits	Test Methods
Resistance Tolerance	Resistance $1\Omega \leq R \pm 5\%$ (J) Resistance Tolerance $1\Omega \leq R \pm 10\%$ (K)	JIS-C-5202 5-1
Temperature Coefficient	$\pm 200\text{ppm}/^\circ\text{C}$ max.	JIS-C-5202 5-2b
Power Rating Load	$\Delta R/R \leq \pm(1\% + 0.05\Omega)$ Surface Temp. Rise 350°C max.	JIS-C-5202 5-4
Short-Time Overload	$\Delta R/R \leq \pm(2\% + 0.05\Omega)$ 100% Rated Power 5 Seconds	JIS-C-5202 5-5
Insulation Resistance	DC500V 100MΩ min	JIS-C-5202 5-6
Dielectric Withstanding Voltage	AC3000V 60Sec.	JIS-C-5202 5-7

